

BEFORE THE ILLINOIS POLLUTION CONTROL BOARD

Smith Agri Service-Barry)
(Property Identification Number) PCB 11-
07-22-100-003) (Tax Certification)
)
)

Clerk
Illinois Pollution Control Board
James R. Thompson Center
100 West Randolph Street, Suite. 11-500
Chicago, Illinois 60601

Jane Smith
29607 253rd Street
Barry, Illinois 62312

Steve Santarelli
Illinois Department of Revenue
101 West Jefferson
Post Office Box 19033
Springfield, Illinois 62794

PLEASE TAKE NOTICE that I have today filed with the Office of the Clerk of the Pollution Control Board an APPEARANCE AND THE RECOMMENDATION of the Illinois Environmental Protection Agency, a copy of which is herewith served upon you.

ENVIRONMENTAL PROTECTION AGENCY
OF THE STATE OF ILLINOIS

By: Vera Herst
Vera Herst
Assistant Counsel
Division of Legal Counsel

DATED: February 15, 2011

Illinois Environmental Protection Agency
1021 North Grand Avenue East
Post Office Box 19276
Springfield, Illinois 62794-9276
(217) 782-5544

THIS FILING IS SUBMITTED ON RECYCLED PAPER

BEFORE THE ILLINOIS POLLUTION CONTROL BOARD

Smith Agri Service-Barry)
(Property Identification Number) PCB 11-
07-22-100-003) (Tax Certification)
)

A P P E A R A N C E

The undersigned, as one of its attorneys, hereby enters an APPEARANCE on behalf of Respondent, Illinois Environmental Protection Agency.

ILLINOIS ENVIRONMENTAL PROTECTION AGENCY

By: Vera Herst
Vera Herst
Assistant Counsel
Division of Legal Counsel

DATED: February 15, 2011
Illinois Environmental Protection Agency
1021 North Grand Avenue East
Post Office Box 19276
Springfield, Illinois 62794-9276
(217)782-5544

THIS FILING IS SUBMITTED ON RECYCLED PAPER

BEFORE THE ILLINOIS POLLUTION CONTROL BOARD

Smith Agri Service-Barry)
(Property Identification Number) PCB 11-
07-22-100-003) (Tax Certification)
)

RECOMMENDATION

The Illinois Environmental Protection Agency ("Illinois EPA") hereby files its Recommendation pursuant to Section 125.204 of the regulations of the Illinois Pollution Control Board, 35 Ill. Adm. Code 125.204.

1. On March 31, 2009, the Illinois EPA received a request from Smith Agri Service, Inc. (log number TC-08-09, Exhibit A) for an Illinois EPA recommendation regarding the tax certification of water pollution control facilities pursuant to 35 Ill. Adm. Code 125.204.
2. The applicant's address is:
Smith Agri Service, Inc.
24375 St. HWY 106
Barry, Illinois 62312

The proposed water pollution control facilities in this request are located at NW 1/4, of Section 22, Township 4S, Range 6W of the 4th PM in Pike County, at the above street address and consist of the following:

Livestock waste management facilities consisting of agrichemical operational area containment structures consisting of three concrete structures and a steel structure as well as associated collection and recovery systems as approved under permit 9204135; and agrichemical secondary containment structures consist of two concrete structures and associated collection and recovery systems as approved under permit 9204135.

These livestock waste management facilities are used to collect, transport and/or store agricultural chemical rinsates, residues, or washwaters prior to reuse or disposal, and are further described in Exhibit A.

4. Section 11-10 of the Property Tax Code, 35 ILCS 200/11-10 (2008), defines “pollution control facilities” as:

“any system, method, construction, device or appliance appurtenant thereto or any portion of any building or equipment, that is designed, constructed, installed or operated for the primary purpose of: (a) eliminating, preventing, or reducing air or water pollution ... or (b) treating, pretreating, modifying or disposing of any potential solid, liquid or gaseous pollutant which if released without treatment, pretreatment modification or disposal might be harmful, detrimental or offensive to human, plant or animal life, or to property.”

5. Pollution control facilities are entitled to preferential tax treatment, 35 ILCS 200/11-5.
6. Based on the information in the application and the purpose of the facilities, it is the Illinois EPA’s engineering judgment that the described facilities may be considered “pollution control facilities,” pursuant to 35 Ill. Adm. Code 125.200(a), with the primary purpose of eliminating, preventing, or reducing water pollution, or as otherwise provided in 35 Ill. Adm. Code 125.200, and are eligible for tax certification from the Board.

WHEREFORE, the Illinois EPA recommends that the Board issue the

requested tax certification.

ILLINOIS ENVIRONMENTAL
PROTECTION AGENCY

By: Vera Herst
Vera Herst
Assistant Counsel
Division of Legal Counsel

Dated: February 15, 2011
Illinois Environmental Protection Agency
1021 North Grand Ave. E.
P.O. Box 19276
Springfield, Illinois 62794-9276
217/782-5544



***** PCB 2011-047 *****
ILLINOIS ENVIRONMENTAL PROTECTION AGENCY

1021 North Grand Avenue East, P.O. Box 19276, Springfield, Illinois 62794-9276 • (217) 782-2829
James R. Thompson Center, 100 West Randolph, Suite 11-300, Chicago, IL 60601 • (312) 814-6026

PAT QUINN, GOVERNOR

DOUGLAS P. SCOTT, DIRECTOR

Memorandum

To: Connie Tonsor, Division of Legal Counsel

From: Al Keller, Manager, Permit Section *AKK*

Date: February 3, 2011

Re: Smith Agri Service, Inc. - Barry
Recommendation of Tax Certification
Log # TC-08-09
Property Identification # 07-22-100-003

The Bureau of Water received a request on March 31, 2009 from Smith Agri Service INC for an Illinois EPA recommendation regarding the tax certification of water pollution control facilities pursuant to 35 IL. Adm. Code 125.204. We offer the following recommendation.

The water pollution control facilities in this request include the following:

Smith Agri Service, Inc.
24375 ST HWY 106
Barry, IL 62312

NW 1/4, of Section 22, Township 4S, Range 6W of the 4th PM in Pike County.

Agrichemical operational area containment structures consisting of two concrete structures and a steel structure as well as associated collection and recovery systems as approved under agrichemical permit #92041345.

Agrichemical secondary containment structures consisting of two concrete structures and associated collection and recovery systems as approved under agrichemical permit #92041345.

These facilities collect, transport, and store agricultural chemical rinsates, residues, or washwaters prior to reuse or disposal.

These facilities are further described in the enclosed applications and supporting documents.

Based on the information included in this submittal, it is our engineering judgment that the above proposed facilities may be considered "Pollution Control Facilities" under 35 IAC 125.200(a), with the primary purpose of eliminating, preventing, or reducing water pollution, or as otherwise provided in this section, and therefore eligible for tax certification from the Illinois Pollution Control Board. The Bureau of Water therefore recommends that the Board issue the requested tax certification for these facilities.

Page No. 2

Log No.

If you have any questions regarding the above, please contact James Blessman at 217/782-3362.

SAK:JTB:TC-08-09_Tax Cert Recommendation_31Mar09.docx

cc: Tax Cert File
JTB

APPLICATION FOR CERTIFICATION (PROPERTY TAX TREATMENT)
 POLLUTION CONTROL FACILITY
 AIR WATER

ILLINOIS ENVIRONMENTAL PROTECTION AGENCY
 P. O. Box 19276, Springfield, IL 62794-9276

This Agency is authorized to request this information under Illinois Revised Statutes, 1979, Chapter, 120, Section 502a-5. Disclosure of this information is voluntary. However, failure to comply could prevent your application from being processed or could result in denial of your application for certification.

FOR AGENCY USE			
File No.	Date Received	Certification No.	Date
APPLICANT	Sec. A Company Name <i>SMITH AGRI SERVICE INC</i>		
	Person Authorized to Receive Certification <i>Jane Smith</i>		Person to Contact for Additional Details <i>Jane Smith</i>
	Street Address <i>29607 253rd St</i>		Street Address <i>29607 253rd St</i>
	Municipality, State & Zip Code <i>BARRY IL 62312</i>		Municipality, State & Zip Code <i>BARRY IL 62312</i>
	Telephone Number <i>217-335-2905</i>		Telephone Number <i>217-335-2905</i>
	Location of Facility Quarter Section Township Range <i>NW 1/4 SEC. 22 BARRY R6W</i>		Municipality Township <i>BARRY BARRY II</i>
	Street Address <i>24375 St HWY 106</i>		County Book Number <i>PIKE DEED Book #107</i>
	Property Identification Number <i>07-22-100-003</i>		Parcel Number <i>46-023-07A</i>
MANUFACTURING OPERATIONS	Sec. B Nature of Operations Conducted at the Above Location <i>Agricultural retail facility. Storage of liquid chemical and fertilizer.</i>		
	Water Pollution Control Construction Permit No. <i>AC 1493030000</i>	Date Issued <i>07/30/2007</i>	
	NPDES PERMIT No. <i>AC 92041345</i>	Date Issued <i>2007</i>	Expiration Date <i>2012</i>
	Air Pollution Control Construction Permit No.	Date Issued	
MANUFACTURING PROCESS	Sec. C Describe Unit Process <i>Storage of liquid chemicals and fertilizers - Containment areas. Blending, loading & unloading on operational areas.</i>		
	Materials Used in Process <i>Agricultural pesticides. Agricultural fertilizers.</i>		
POLLUTION CONTROL FACILITY DESCRIPTION	Sec. D Describe Pollution Abatement Control Facility <i>Liquid fertilizer and chemical containment with two operational areas for loading and blending. See attach renewal permit for dimensions. IDDA + IEPA. Original permits were issued 1992 - 1994.</i>		

Sec. E	(1) Nature of Contaminants or Pollutants		
CONTAMINANTS		Material Retained, Captured or Recovered	
	Contaminant or Pollutant	DESCRIPTION	DISPOSAL OR USE
	<i>Pesticide or fertilizer</i>	<i>Residue</i>	<i>Spread on agricultural fields</i>
ACCOUNTING DATA	(2) Point(s) of Waste Water Discharge <i>No points of waste water discharge. All waste water contained and spread in agricultural fields.</i>		
	Plans and Specifications Attached		Yes <input type="checkbox"/> No <input checked="" type="checkbox"/>
	(3)	Are contaminants (or residues) collected by the control facility?	Yes <input checked="" type="checkbox"/> No <input type="checkbox"/>
	(4)	Date installation completed <i>100%</i> status of installation on date of application <i>1993-1994</i>	
	(5)	a. FAIR CASH VALUE IF CONSIDERED REAL PROPERTY:	\$ <i>76,470</i>
		b. NET SALVAGE VALUE IF CONSIDERED REAL PROPERTY:	\$ <i>5,000</i>
		c. PRODUCTIVE GROSS ANNUAL INCOME OF CONTROL FACILITY:	\$ <i>1,416,000</i>
		d. PRODUCTIVE NET ANNUAL INCOME OF CONTROL FACILITY:	\$ <i>27,000</i>
		e. PERCENTAGE CONTROL FACILITY BEARS TO WHOLE FACILITY VALUE:	%
	Sec. F	The following information is submitted in accordance with the Illinois Property Tax Code, as amended, and to the best of my knowledge, is true and correct. The facilities claimed herein are "pollution control facilities" as defined in Section 11-10 of the Illinois Property Tax Code. <div style="display: flex; justify-content: space-between;"> <div style="width: 30%; text-align: center;"> <i>Jane Smith</i> Signature </div> <div style="width: 30%; text-align: center;"> <i>Sec / Treas</i> Title </div> </div>	
Sec. G	INSTRUCTIONS FOR COMPILING AND FILING APPLICATION		
	General: Separate applications must be completed for each control facility claimed. Do not mix types (water and air). Where both air and water operations are related, file two applications. If attachments are needed, record them consecutively on an index sheet.		
INSTRUCTIONS	Sec. A	Information refers to applicant as listed in the tax records and the person to be contacted for further details or for inspection of facilities. Define facility location by street address or legal description. A plat map location is required for facilities located outside of municipal boundaries. The property identification number is required.	
	Sec. B	Self-explanatory. Submit copies of all permits issued by local pollution control agencies. (e.g. MSD Construction Permit)	
	Sec. C	Refers to manufacturing processes or materials on which pollution control facility is used.	
	Sec. D	Narrative description of the pollution control facility, indicating that its primary purpose is to eliminate, prevent or reduce pollution. State the type of control facility. State permit number, date, and agency issuing permit. A narrative description and a process flow diagram describing the <u>pollution control facility</u> . Include a listing of each major piece of equipment included in the claimed fair cash value for real property. Include an <u>average</u> analysis of the influent and effluent of the control facility stating the collection efficiency.	
	Sec. E	List air contaminants, or water pollution substances released as effluents to the manufacturing processes. List also the final disposal of any contaminants removed from the manufacturing processes. Item (1) - Refers to pollutants and contaminants removed from the process by the pollution control facility. Item (2) - Refers to water pollution but can apply to water-carried wastes from air pollution control facilities. Submit drawings, which clearly show (a) Point(s) of discharge to receiving stream, and (b) Sewers and process piping to and from the control facility. Item (3) - If the collected contaminants are disposed of other than as wastes, state the disposition of the materials, and the value in dollars reclaimed by sale or reuse of the collected substances. State the cost of reclamation and related expense. Item (4) - State the date which the pollution control facility was first placed in service and operated. If not, explain. Item (5) - This information is essential to the certification and assessment actions. This accounting data must be completed to activate project review prior to certification by this Agency.	
	Sec. F	Self-explanatory. Signature must be a corporate authorized signature.	
		Submit to:	Attention:
		Illinois EPA P.O. Box 19276 Springfield, IL 62794-9276	Ai Keller Permit Section Division of Water Pollution Control
			Attention: Donald E. Sutton Permit Section Division of Air Pollution Control



Rod R. Blagojevich, Governor • Chuck Hartke, Director

Bureau of Environmental Programs

State Fairgrounds • P.O. Box 19281 • Springfield, IL 62794-9281 • 217/785-2427 (voice/TDD) • Fax 217/524-4882
Pesticide Misuse Hotline 1-800-641-3934 (voice/TDD)

July 30, 2007

Smith Agri-Service, Inc.
29607 253rd St
Barry, IL 62312

Dear Agrichemical Facility Permit Applicant:

Enclosed is the construction and/or operating permit as approved by the Illinois Department of Agriculture and endorsed by the Illinois Environmental Protection Agency. Please carefully review and follow the Standard and Special Conditions of the Permit and Endorsement.

Prior to construction, the Department and the Agency caution you to carefully evaluate past operational practices at the site. Should you suspect environmental (soil, surface or groundwater) contamination, it is advisable to determine the extent and severity of such contamination prior to construction and remediate these areas as required.

We appreciate your cooperation with the Department in this process. Should you have any questions or comments regarding your Agrichemical Facility Permit, please contact the Agrichemical Containment Program at (217) 785-0780.

Sincerely,

Handwritten signature of Warren D. Goetsch.

Warren D. Goetsch, P.E.
Chief, Bureau of Environmental Programs

Handwritten signature of Gerald C. Kirbach.

Gerald C. Kirbach, Manager
Permits and Downstate Field Operations

xc:IEPA:WPC:Permits
a: 149303.cov

State of Illinois
Department of Agriculture
AGRICHEMICAL CONTAINMENT PERMIT

Permittee:		Facility ID Number:	AC1493030000
	Smith Agri-Service, Inc. 29607 253rd St Barry, IL 62312	Facility Location:	Barry, IL
Permit #:	AC92041345	Log Number:	07048902
Facility Type:	Commercial: Retail Dealer	Date Received:	April 23, 2007
Date Issued:	July 20, 2007	Expiration Date:	July 20, 2012

Permit is hereby granted to the above designated permittee to construct and operate an agrichemical containment facility as follows:

OPERATIONAL CONTAINMENT STRUCTURES

Operation of an existing reinforced concrete operational containment structure measuring 16' (width) x 42' (length) x 0.83' (depth) with a total design capacity of 269 cubic feet (ft.³). The floor shall slope to a single sump measuring 2' (width) x 6' (length) x 2' (depth) to facilitate the collection and recovery of all escaped product and/or agrichemical wastewater. All recovered effluent shall be transferred to one (1) of two (2) 1,650 gallon recovery tanks with a manually activated sump pump. Segregation shall be performed based upon the applicable target crop and label use. The loading, unloading, and washing of bulk liquid agrichemical transportation and application equipment shall be performed upon the herein permitted structure. This structure shall be referred to as OC-1.

Operation of an existing reinforced concrete operational containment structure measuring 10.3' (width) x 10.3' (length) x 4' (depth) with a total design capacity of 325 cubic feet (ft.³). The floor shall slope to a single sump measuring 1' (diameter) x 1' (depth) to facilitate the collection and recovery of all escaped product and/or agrichemical wastewater. All recovered effluent shall be transferred to one (1) of the two (2) aforementioned 1,650 gallon recovery tanks with a manually activated sump pump. Segregation shall be performed based upon the applicable target crop and label use. The mixing of liquid agrichemicals shall be performed upon the herein permitted structure. This structure shall be referred to as OC-2.

Operation of an existing reinforced concrete operational containment structure measuring 16' (width) x 32' (length) x 1' (depth) with a total design capacity of 434 cubic feet (ft.³). The floor shall slope to a single sump measuring 3' (width) x 15.33' (length) x 3' (depth) to facilitate the collection and recovery of all escaped product and/or agrichemical wastewater. All recovered effluent shall be transferred to one (1) of the two (2) aforementioned 1,650 gallon recovery tanks with a manually activated sump pump. Segregation shall be performed based upon the applicable target crop and label use. The loading, unloading and washing of bulk liquid agrichemical transportation and application equipment shall be performed upon the herein permitted structure. This structure shall be referred to as OC-3.



State of Illinois
Department of Agriculture

Smith Agri-Service

AGRICHEMICAL CONTAINMENT PERMIT

Page: 2

Operation of an existing stainless steel operational containment structure measuring 5' (width) x 6' (length) x 1' (depth) with a total design capacity of 30 cubic feet (ft.³). The floor shall slope to the lowest elevation to facilitate the collection and recovery of all escaped product and/or agrichemical wastewater. All recovered effluent shall be transferred to one (1) of the two (2) 1,650 gallon recovery tanks with a manually activated sump pump. Segregation shall be performed based upon the applicable target crop and label use. The repackaging of bulk liquid agrichemicals shall be performed upon the herein permitted structure. This structure shall be referred to as OC-4.

SECONDARY CONTAINMENT STRUCTURES

Operation of an existing reinforced concrete secondary containment structure with the greatest dimensions measuring 32' (width) x 42' (length) x 1.75' (height) with a total design capacity of 883 cubic feet (ft.³). The floor shall slope to a single sump measuring 1' (diameter) x 1' (depth) to facilitate the collection and recovery of all escaped product and/or agrichemical wastewater. All recovered effluent shall be transferred to one (1) of the two (2) aforementioned 1,650 gallon recovery tanks with a manually activated sump pump. Segregation shall be performed based upon the applicable target crop and label use. All bulk liquid pesticides shall be stored within the herein permitted structure. This structure shall be referred to as SC-1.

Operation of an existing reinforced concrete secondary containment structure measuring 32' (width) x 48' (length) x 1.25' (height) with a total design capacity of 1,830 cubic feet (ft.³). The floor shall slope to a single sump measuring 1' (diameter) x 1' (depth) to facilitate the collection and recovery of all escaped product and/or agrichemical wastewater. All recovered effluent shall be transferred to one (1) of the two (2) aforementioned 1,650 gallon recovery tanks with a manually activated sump pump. Segregation shall be performed based upon the applicable target crop and label use. All bulk liquid fertilizer shall be stored within the herein permitted structure. This structure shall be referred to as SC-2.

There shall be no discharge of wastewater from the herein permitted facilities.

This permit has been reviewed and approved by the Illinois Environmental Protection Agency per the attached permit endorsement. This permit is subject to standard conditions on the reverse side of this document and the following special conditions:

SPECIAL CONDITION 1: The permittee shall provide backflow protection in accordance with the Illinois Department of Public Health Plumbing Code (77 Ill. Adm. Code 890) and the Illinois Environmental Protection Agency's Technical Policy Statement (35 Ill. Adm. Code 653.803(c)(4).

STANDARD CONDITIONS OF ISSUANCE ON THE REVERSE SIDES OF THIS MUST BE COMPLIED WITH IN FULL.

Warren D. Goetsch

Warren D. Goetsch, P.E.
Chief, Bureau of Environmental Programs

Gerald C. Kirbach

Gerald C. Kirbach, Manager
Permits and Downstate Field Operations

cc: Illinois EPA: WPC: Permits
a: 149303.per





ILLINOIS ENVIRONMENTAL PROTECTION AGENCY

1021 NORTH GRAND AVENUE EAST, P.O. BOX 19276, SPRINGFIELD, ILLINOIS 62794-9276 - (217) 782-3397

JAMES R. THOMPSON CENTER, 100 WEST RANDOLPH, SUITE 11-300, CHICAGO, IL 60601 - (312) 814-6026

ROD R. BLAGOJEVICH, GOVERNOR

DOUGLAS P. SCOTT, DIRECTOR

217/782-3362

JUL 20 2007

Bureau of Environmental Programs
Illinois Department of Agriculture
State Fairgrounds
Post Office Box 19281
Springfield, Illinois 62794-9281

Re: Smith Ag Service, Inc. - Barry -- Endorsement of Agrichemical Facility Permit
Log No. 07048902
Renewal

Gentlemen:

Based on the information included in the permit application, the subject facility may be constructed and operated so as to meet the requirements of Subtitle C: Water Pollution and Subtitle B: Air Pollution.

This Agency hereby issues endorsement pursuant to Section 39.4 of the Illinois Environmental Protection Act for the subject agrichemical facility subject to the following Special Conditions:

Special conditions in the general endorsements for previous agrichemical facility permit modifications for this facility will remain valid for the subject permit modifications regardless of subsequent modification, renewal or expiration of the general endorsements.

SPECIAL CONDITION NO. 1: Dry fertilizer blending and blending of pesticides onto dry fertilizer is not allowed at this facility. A revised operating permit is required for such blending operations.

SPECIAL CONDITION NO. 2: No person shall cause or allow any visible emissions of fugitive particulate matter from any process, including any material handling or storage activity beyond the property line of the emission source, pursuant to 35 Ill. Adm. Code 212.301.

This endorsement becomes effective and is deemed to be a permit issued by the Agency pursuant to Sections 9(b) and 12(b) of the Act when the Illinois Department of Agriculture includes the above conditions as conditions of a permit issued pursuant to Section 255.50 of Subchapter i, Chapter I of Title 8: Agriculture and Animals.

ROCKFORD - 4302 North Main Street, Rockford, IL 61103 - (815) 987-7760 • DES PLAINES - 9511 W. Harrison St., Des Plaines, IL 60016 - (847) 294-4000

ELGIN - 595 South State, Elgin, IL 60123 - (847) 608-3131 • PEORIA - 5415 N. University St., Peoria, IL 61614 - (309) 693-5463

BUREAU OF LAND - PEORIA - 7620 N. University St., Peoria, IL 61614 - (309) 693-5462 • CHAMPAIGN - 2125 South First Street, Champaign, IL 61820 - (217) 276-5800

SPRINGFIELD - 4500 S. Sixth Street Rd., Springfield, IL 62706 - (217) 786-6892 • COLLINSVILLE - 2009 Mall Street, Collinsville, IL 62234 - (618) 346-5120

MARION - 2309 W. Main St., Suite 116, Marion, IL 62959 - (618) 993-7200

Page No. 2
Log No. 07048902

This endorsement does not grant immunity from enforcement action found necessary by this Agency to meet its responsibilities in prevention, abatement, and control of water or air pollution.

Very truly yours,



Bruce J. Yurdin
Manager, Watershed Management Section
Bureau of Water

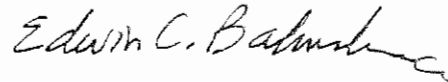

Edwin C. Bakowski, P.E.
Acting Manager, Permit Section
Division of Air Pollution Control

BJY:JRA\

cc: Region 5 - Springfield
Records Unit
DAPC/Permits
DAPC/Region 2 - Peoria (Pike County)

BARRY

T.4S.-R.6W.

ADAMS COUNTY

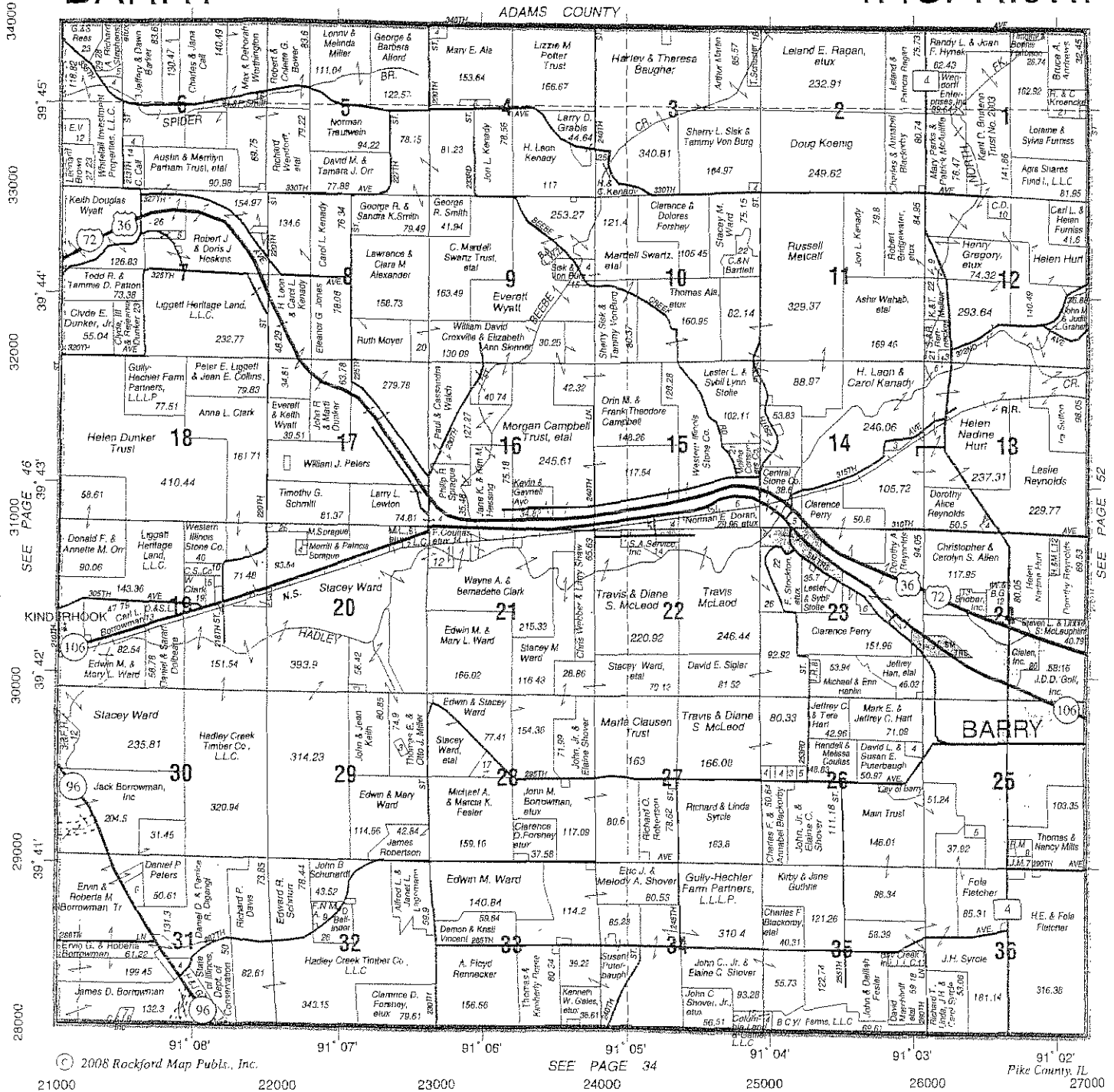

LIKES Land Surveyors, Inc.

9 Kendall Avenue, P.O. Box 103, Barry, Illinois 62312
 Phone: 217-335-2129 - Fax: 217-335-2550 - Website: www.likeslandsurveyors.com

Boundary and Topographic Surveys - ALTA/ACSM Surveys
 Construction Staking - Subdivisions - Rural and Urban Surveys

Providing Professional Land Surveying Services in Illinois and Missouri since 1976

***** PCB 2011-047 *****

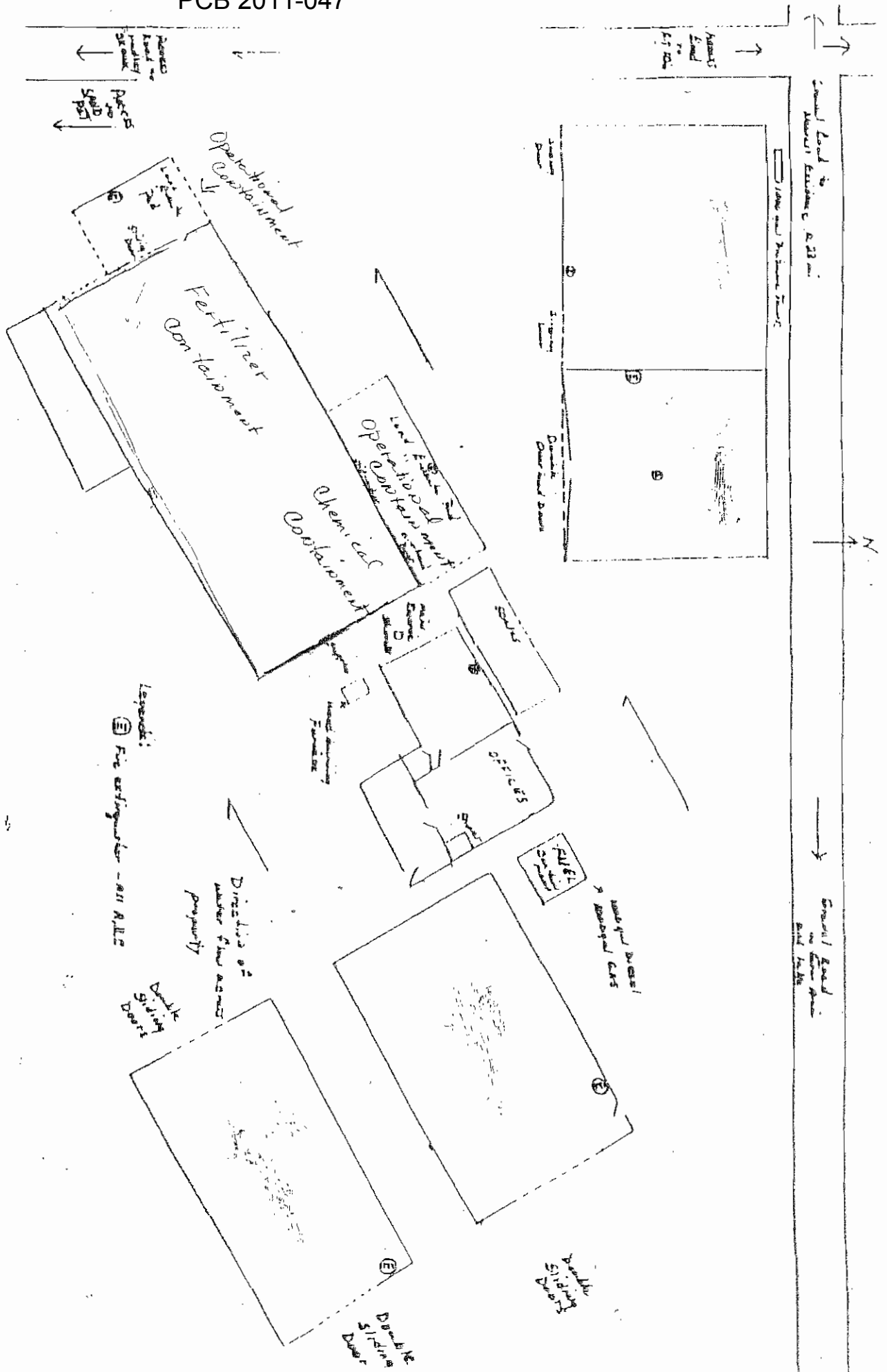

Anhydrous Ammonia Tank wagon location

Emergency Response + Contingency
Plan
Tier II Submission

Smith Agri-Service, Inc.
29607 253rd St
Barry, IL 62312
217-335-2905

March 27, 2009

Illinois EPA
P.O. Box 19276
Springfield, IL 62794-9276

Attention: Al Keller
Permit Section
Division of Water Pollution Control

Dear Sir:

Enclosed is my "application for certification (property tax treatment) pollution control facility".

Attachment 1 – Agrichemical Containment Permit from the Illinois Department of Agriculture and the Illinois EPA. Dated 7/30/2007

Attachment 2 – Plat for Barry Township

Attachment 3 – Plot Plan of our facility.

If there is any additional information or clarification needed, please contact me. Thank you.

Sincerely,



Jane Smith
Secretary/Treasurer
Smith Agri-Service, Inc.
217-335-2905

RECEIVED
MAR 31 2009

ILLINOIS ENVIRONMENTAL
PROTECTION AGENCY
BOW/WPC/PERMIT SECTION

Watershed Unit Tax Certification Review Sheet

Project Name: Smith Agri Service INC

Location: Barry

Reviewer: JTB

Date: January 5, 2011

Log number: TC-08-09

Type: Agchem
 LivestockApplicant: Smith Agri Service INC
29607 253rd ST
Barry, IL 62312

Contact: Jane Smith

Phone: (217) 335-2905

Facility: Smith Agri Service INC
24375 ST HWY 106
Barry, IL 62312

Property ID: 07-22-100-003

County: Pike

Legal Description:
S: NW 1/4, of Section 22 Twp: 4S R: 6W PM: 4th

Signature: Jane Smith

Title: Sec/Treasurer

Date Control Devices installed: 1993

Provided Fair cash Value: \$76,470

Wastes: Livestock waste is applied to cropland.
 Agrichemical rinsate and spillage is recycled through the facility and/or land applied.
 Other: _____

Physical Description of Pollution Control Devices:

Agrichemical operational area containment structures consisting of a concrete structure approximately (16 ft. x 42 ft. x 10 inch) with a sump approximately (2 ft. x 6 ft. x 2 ft.); a concrete structure approximately (10.3 ft. x 10.3 ft. x 4 ft.) with a sump approximately (1 ft. in diameter x 1 ft. in depth); a concrete structure approximately (16 ft. x 32 ft. x 1 ft.) with a sump approximately (3 ft. x 15.3 ft. x 3 ft.); and a steel structure approximately (5 ft. x 6 ft. x 1 ft. in depth). Agrichemical secondary containment structures consist of a concrete structure approximately (32 ft. x 42 ft. x 1.75 ft.) with a sump of approximately (1 ft. in diameter x 1 ft.); and a concrete structure approximately (32 ft. x 48 ft. x 1.25 ft.) with a sump of (1 ft. diameter x 1 ft.) These structures are approved under Agrichemical Facility Permit no. 92041345.

These facilities collect, transport, and store agricultural chemical rinsates, residues, or washwaters prior to reuse or disposal.

The 16' x 42' x .83' containment, the 10.3' x 10.3' x 4' containment and the 32' x 42 x 1.75' secondary containment were constructed under permit 92041345 issued 3/30/92 log number 92041345.

The 16' x 32' 1' containment and the 32' x 48' 1.25' secondary containment were constructed under permit 92041345 modified 4/16/93 log number 93032090.

The 5' x 6' x 1' stainless steel containment was constructed under permit 92041345 modified 11/5/93 log number 93102445.

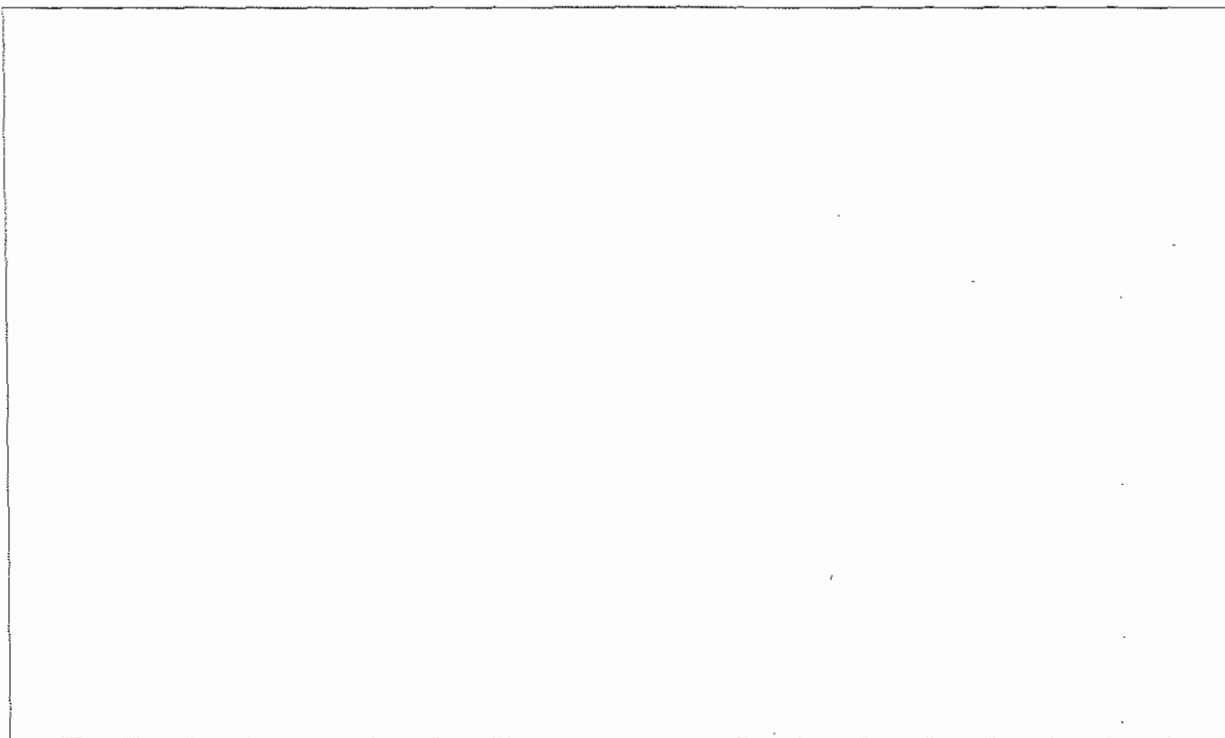

drg/taxcert review sheet

ILLINOIS DEPARTMENT OF AGRICULTURE
AGRICHEMICAL FACILITY PERMIT

Permittee:
Smith Agri-Service
Rt. 1 - Box 121
Barry, IL 62312

Facility ID Number: 1493030000
Facility Location: Barry, IL

*Copied to: DAPC Permits - Don Hanko
" Region - Peoria
DAPC " - Springfield
" Records
" Binds
4-20-92
JH*

Permit Number: 92041345
Facility Type: Commercial: Retail Dealer
Date Issued: March 30, 1992

Log Number: 92041345
Date Received: March 23, 1992
Permit Expiration Date: March 30, 1997

Permit is hereby granted to the above designated permittee to construct and operate an agrichemical containment facility as follows:

OPERATIONAL CONTAINMENT STRUCTURES:

Installation and operation of a reinforced concrete operational containment structure measuring 16' (width) x 42' (length) x .83' (depth) with a total design capacity of 269 cubic feet (ft³). The floor shall slope to a single sump measuring 2' (width) x 6' (length) x 2' (depth) to facilitate the collection and recovery of all escaped product and/or agrichemical wastewater. All recovered effluent shall be transferred to one (1) of two (2) 1650 gallon recovery tanks with a manually activated sump pump. Segregation shall be performed based upon the applicable target crop and label use. All washing and loading of agrichemical transportation and application equipment and the unloading of bulk liquid pesticides shall be performed upon the herein permitted structure.

Installation and operation of a reinforced concrete operational containment structure measuring 10.3' (width) x 10.3' (length) x 4' (depth) with a total design capacity of 325 cubic feet (ft³). The floor shall slope to a single sump measuring 1' (diameter) x 1' (depth) to facilitate the collection and recovery of all escaped product and/or agrichemical wastewater. All recovered effluent shall be transferred to one (1) of the two (2) aforementioned 1650 gallon recovery tanks with a manually activated sump pump. Segregation shall be performed based upon the applicable target crop and label use. All mixing of liquid agrichemicals shall be performed upon the herein permitted structure.

SECONDARY CONTAINMENT STRUCTURES:

Installation and operation of a reinforced concrete secondary containment structure measuring 32' (width) x 42' (length) x 1.75' (height) with a total design capacity of 883 cubic feet (ft³). (This shall exclude the segregated 10.3' (width) x 10.3' (length) mix area). The floor shall slope to a single sump measuring 1' (diameter) x 1' (depth) to facilitate the collection and recovery of all escaped product and/or agrichemical wastewater. All recovered effluent shall be transferred to one (1) of the two (2) aforementioned 1650 gallon recovery tanks with a manually activated sump pump. Segregation shall be performed based upon the applicable target crop and label use. All recovered effluents and bulk liquid pesticides shall be stored within the said structure.



ILLINOIS DEPARTMENT OF AGRICULTURE
AGRICHEMICAL FACILITY PERMIT

Smith Agri-Service /Page 2

There shall be no discharge of wastewater from the herein permitted facilities.

This permit has been reviewed and approved by the Illinois Environmental Protection Agency per the attached permit endorsement. This permit is subject to standard conditions on the reverse side of this document and the following special conditions:

SPECIAL CONDITION 1: The permittee shall provide backflow protection in accordance with the Illinois Department of Public Health Plumbing Code (77 Ill. Adm. Code 890) and the Illinois Environmental Protection Agency's Technical Policy Statement (35 Ill. Adm. Code 653.803(c)(4).

SPECIAL CONDITION 2: This permit shall exclude all bulk liquid fertilizer storage structures as well as all bulk dry fertilizer handling, storage and blending operations and all associated operational and storage structures. The permittee shall adhere to the previously established compliance date for bulk liquid and dry fertilizer pursuant to 8 Illinois Administrative Code 255.50.

THE STANDARD CONDITIONS OF ISSUANCE ON THE REVERSE SIDES OF THIS MUST BE COMPLIED WITH IN FULL.



Warren D. Goetsch, P.E.
Chief, Bureau of Environmental Programs



Gerald C. Kirbach, Manager
Permits and
Downstate Field Operations

cc: Illinois EPA: WPC: Permits
file
a:149303.per



mk

ILLINOIS DEPARTMENT OF AGRICULTURE

AGRICHEMICAL FACILITY PERMIT

RECEIVED

*Copied to: DAPC Permits - Don Hanko DWPC Records
 DAPC Region - Peoria DWPC Binds
 DWPC Region - Springfield*

MAY 20 1993

5-21-93 bh

AGRICHEMICAL FACILITY PERMIT MODIFICATION

Environmental Protection Agency
 Division of Water Pollution Control
 Permit Section-Springfield
 State of Illinois

Permittee: Smith Agri-Service Rt. 1 - Box 121 Barry, IL 62312	Facility ID Number: 1493030000 Facility Location: Barry, IL
Permit Number: 92041345 Facility Type: Commercial: Retail Dealer Date Issued: April 16, 1993	Log Number: 93032090 Date Received: March 17, 1993 Permit Expiration Date: March 30, 1997

A permit modification is hereby granted to the above designated permittee to construct and/or operate an agrichemical facility which was previously approved under the above referenced permit number. The facility and associated permit has been modified as follows:

OPERATIONAL CONTAINMENT STRUCTURES:

Installation and operation of a reinforced concrete operational containment structure measuring 16' (width) x 32' (length) x 1' (depth) with a total design capacity of 433.7 cubic feet (ft³). The floor shall slope to a single sump measuring 3' (width) x 15.33' (length) x 3' (depth) to facilitate the collection and recovery of all escaped product and/or agrichemical wastewater. All recovered effluent shall be transferred to one (1) of two (2) 1650 gallon recovery tanks with a manually activated sump pump. Segregation shall be performed based upon the applicable target crop and label use. All loading and unloading of bulk liquid fertilizer transportation and application equipment shall be performed upon the herein permitted structure.

SECONDARY CONTAINMENT STRUCTURES:

Installation and operation of a reinforced concrete secondary containment structure measuring 32' (width) x 48' (length) x 1.25' (depth) with a total design capacity of 1829.6 cubic feet (ft³). The floor shall slope to a single sump measuring 1' (width) x 1' (depth) to facilitate the collection and recovery of all escaped product and/or agrichemical wastewater. All recovered effluent shall be transferred to one (1) of the two (2) aforementioned 1650 gallon recovery tanks with a manually activated sump pump. Segregation shall be performed based upon the applicable target crop and label use. All bulk liquid fertilizers shall be stored within the herein permitted structure.



ILLINOIS DEPARTMENT OF AGRICULTURE
AGRICHEMICAL FACILITY PERMIT

Smith Agri-Service/Page 2

This permit modification has also been reviewed and approved by the Illinois Environmental Protection Agency per the attached permit modification endorsement. The expiration date of the permit modification is the same as for the expiration date of the original permit.

All Special Conditions on the original permit issued are also applicable to this permit unless specifically deleted or revised in this permit.

This permit is issued subject to the Following Conditions. If such Special Conditions requires additional or revised plans, structures or operations, satisfactory documents (i.e. engineering plans or management techniques) must be submitted to the Department for review and approval.

SPECIAL CONDITION 1: Special Condition #2 of permit number 92041345 shall be modified to read as follows:

This permit shall exclude all bulk dry fertilizer handling, storage and blending operations and all associated structures. The permittee shall adhere to the previously established compliance date for bulk dry fertilizer pursuant to 8 Illinois Administrative Code 255.50.

THE STANDARD CONDITIONS OF ISSUANCE IN THE ATTACHED PAGES MUST BE COMPLIED WITH IN FULL.

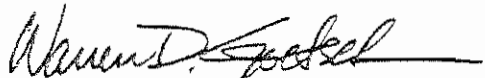

Warren D. Goetsch, P.E.
Chief, Bureau of Environmental Programs

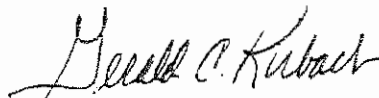

Gerald C. Kirbach, Manager
Permits and
Downstate Field Operations

cc: IEPA:WPC:Permits
file
a:149303.pm



ILLINOIS DEPARTMENT OF AGRICULTURE

AGRICHEMICAL FACILITY PERMIT

Copy to: DAPC-Records Don Hanko DAPC-Records
 DAPC-Region Peoria DAPC-Bands
 DAPC-Region Springfield

11-23-93

AGRICHEMICAL FACILITY PERMIT MODIFICATION

NOV 23 1993

Permittee:	Smith Agri-Service RT-1 - Box 121 Barry, IL 62312	Facility ID Number:	1493030000
		Facility Location:	Barry, IL
Permit #:	92041345	Log Number:	93102445
Facility Type:	Commercial: Retail Dealer	Date Received:	October 8, 1993
Date Issued:	November 5, 1993	Expiration Date:	March 30, 1997

A permit modification is hereby granted to the above designated permittee to construct and/or operate an agrichemical facility which was previously approved under the above referenced permit number. The facility and associated permit has been modified as follows:

OPERATIONAL CONTAINMENT STRUCTURES:

Installation and operation of a stainless steel operational containment structure measuring 5' (width) x 6' (length) x 1' (depth) with a total design capacity of 30.0 cubic feet (ft³). The floor shall slope to the lowest elevation to facilitate the collection and recovery of all escaped product and/or agrichemical wastewater. All recovered effluent shall be transferred to one (1) of two (2) 1650 gallon recovery tanks with a manually activated sump pump. Segregation shall be performed based upon the applicable target crop and label use. All repackaging of mini-bulk agrichemical containers shall be performed upon the herein permitted structure. This structure shall be located within the previously permitted bulk liquid pesticide secondary containment structure.

SECONDARY CONTAINMENT STRUCTURES:

The addition of three (3) bulk liquid pesticide storage tanks (two (2) tanks with a capacity of 1050 gallons each and one (1) tank with a capacity of 500 gallons) to the bulk liquid pesticide secondary containment structure previously permitted under Permit #92041345.

This permit modification has also been reviewed and approved by the Illinois Environmental Protection Agency per the attached permit modification endorsement. The expiration date of the permit modification is the same as for the expiration date of the original permit.

All Special Conditions on the original permit issued are also applicable to this permit unless specifically deleted or revised in this permit.



ILLINOIS DEPARTMENT OF AGRICULTURE
AGRICHEMICAL FACILITY PERMIT

Smith Agri-Service /Page 2

THE STANDARD CONDITIONS OF ISSUANCE IN THE ATTACHED PAGES MUST BE
COMPLIED WITH IN FULL.

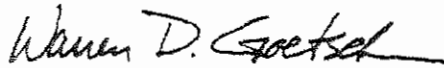

Warren D. Goetsch, P.E.
Chief, Bureau of Environmental Programs

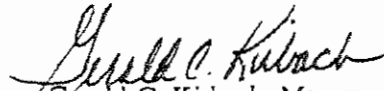

Gerald C. Kirbach, Manager
Permits and Downstate
Field Operations

cc: IEPA:WPC:Permits
file
a:149303.2pm



STATE OF ILLINOIS)
)
)
COUNTY OF SANGAMON)
)

PROOF OF SERVICE

I, the undersigned attorney at law, hereby certify that on February 15, 2011, I served true and correct copies of an APPEARANCE AND THE RECOMMENDATION, upon the persons and by the methods as follows:

[1st Class U.S. Mail]

Steve Santarelli
Illinois Department of Revenue
101 West Jefferson
Post Office Box 19033
Springfield, Illinois 62794

[1st Class U.S. Mail]

Jane Smith
29607 253rd Street
Barry, Illinois 62312

[Electronic Filing]

Clerk
Illinois Pollution Control Board
James R. Thompson Center
100 West Randolph Street, Suite. 11-500
Chicago, Illinois 60601

ILLINOIS ENVIRONMENTAL PROTECTION AGENCY

/s/ Vera Herst
Assistant Counsel
Division of Legal Counsel
1021 North Grand Avenue East
P.O. Box 19276-
Springfield, Illinois 62794-9276
217.782.5544
217.782.9143 (TDD)

THIS FILING IS SUBMITTED ON RECYCLED PAPER